

**DISTRICT OF CHETWYND**

**BYLAW NO. 691/G/97**

**A Bylaw to Establish a Specified Area for the  
Purpose of Providing Fire Protection Services to an  
Area Within the District of Chetwynd**

WHEREAS Division (2) of Part 19 of the *Municipal Act* being Chapter 323, R.S.B.C., 1996 and all amendments thereto, provides Council with the authority to establish specified areas for the purpose of providing fire protection;

AND WHEREAS it is deemed expedient to provide fire protection services within a specified area of the District of Chetwynd;

AND WHEREAS an area was newly established to be included within the District of Chetwynd's municipal boundaries by Supplementary Letters Patent, issued by Order in Council Number 1423, approved and ordered December 4, 1996;

AND WHEREAS the Supplementary Letters Patent requires the District of Chetwynd to establish by bylaw a specified area respecting the newly included area of the municipality that will be benefited;

AND WHEREAS Section 646, subsection (6) of the *Municipal Act* does not apply to the enactment of this bylaw;

NOW THEREFORE the Council of the District of Chetwynd in open meeting assembled enacts as follows:

1. This Bylaw shall be cited as "District of Chetwynd Fire Specified Area Protection Services Establishment Bylaw No. 691/G/97".
2. The Council of the District of Chetwynd is hereby empowered and authorized:
  - 1) to establish a specified area hereinafter referred to as the District of Chetwynd Fire Protection Services Specified Area and such area shall comprise of all the lands within the District of Chetwynd municipal boundaries with the exception of the lands more commonly known as Pine Valley Coal Ltd. (Globaltex Coal Corporation), Petrosul International Ltd., Westcoast Energy Inc., and Louisiana-Pacific Canada Ltd. and more particularly described in Schedule "A" as referenced to Thirdly, Fourthly, Fifthly and Sixthly in the District of Chetwynd Supplementary Letters Patent issued by Order in Council Number 1423 and outlined on Schedule "B" which are attached to and form part of this bylaw.
  - 2) to undertake and carry out or cause to be carried out works in accordance with plans on file in the office of the municipality and to do all things necessary in connection therewith and without limiting the generality of the foregoing;
  - 3) the cost of providing the fire protection services shall be borne by the owners of the land in the said specified area, and a sum sufficient therefore shall be recovered for such period of time as is necessary by the imposition of a land and improvement tax to be imposed by bylaw;

**DISTRICT OF CHETWYND**

**Schedule "A"**

**Fire Protection Services Specified Area**

All of the lands within the District of Chetwynd municipal boundaries are established as the municipal fire protection services specified area with the following exceptions:

Industrial Site	Legal Description as Referenced to in the District of Chetwynd Supplementary Letters Patent issued by Order in Council Number 1423
Pine Valley Coal Ltd. (Globaltex Coal Corporation)	Thirdly: Commencing at the southeast corner of Lot 1147, Peace River Land District; thence westerly along the southerly boundary of said Lot 1147 to the southwest corner thereof; thence southerly and westerly along the easterly and southerly boundaries of Lot 377 to the point of intersection with the southeasterly limit of British Columbia Railway Company's right of way, and shown as Lot 3592; thence southwesterly along the said southeasterly limit of British Columbia Railway Company's right of way, Lot 3592 to the point of intersection with the easterly boundary of Lot 379; thence southerly and westerly along the easterly and southerly boundaries of said Lot 379 to the southwest corner thereof; thence southerly along the easterly boundary of Lot 380 and continuing southerly along the southerly prolongation thereof, to the point of intersection with the easterly prolongation of the southerly boundary of Lot 381; thence easterly along the said easterly prolongation of the southerly boundary of Lot 381 to the point of intersection with the southerly prolongation of the easterly boundary of Lot 377; thence due south 250 metres; thence due east 1,800 metres; thence due south to the point of intersection with the easterly prolongation of the southerly boundary of Lot 383; thence easterly along said easterly prolongation to the point of intersection with the southerly prolongation of the easterly boundary of Lot 369; thence northerly along said southerly prolongation to the point of intersection with the easterly prolongation to the aforesaid southeast corner of Lot 1147, being the point of commencement and containing by admeasurement 1,465.0 hectares of land, more or less.
Petrosul International Ltd.	Fourthly: British Columbia Railway Limited Lease Number 2193 (Petrosul International Limited); British Columbia Railway Limited Lease Number 2819 (Westcoast Energy Limited); and British Columbia Railway Limited Lease Number TS 345 (siding agreement, Petrosul International Limited); the above being within Lots 357 and 1131, Peace River Land District, west of the confluence of Hasler Creek and Pine River, and the leases containing by admeasurement 11.0 hectares of land, more or less.
Westcoast Energy Inc.	Fifthly: Lot 1156, Peace River Land District containing by admeasurement 78.00 hectares of land, more or less.
Louisiana-Pacific Canada Ltd.	Sixthly: Lot 1767, Peace River Land District, excluding therefrom: i) that part of road right of way known as Road Thirty-Four and ii) that part of road right of way shown on Registered Plan 34539, on file in the Land Title Office, Prince George, being the westerly 80 feet of Lot 1767, and containing by admeasurement 254.00 hectares of land, more or less.



# DISTRICT OF CHETWYND

## PROPOSED BOUNDARY EXPANSION

SEPTEMBER - 1995

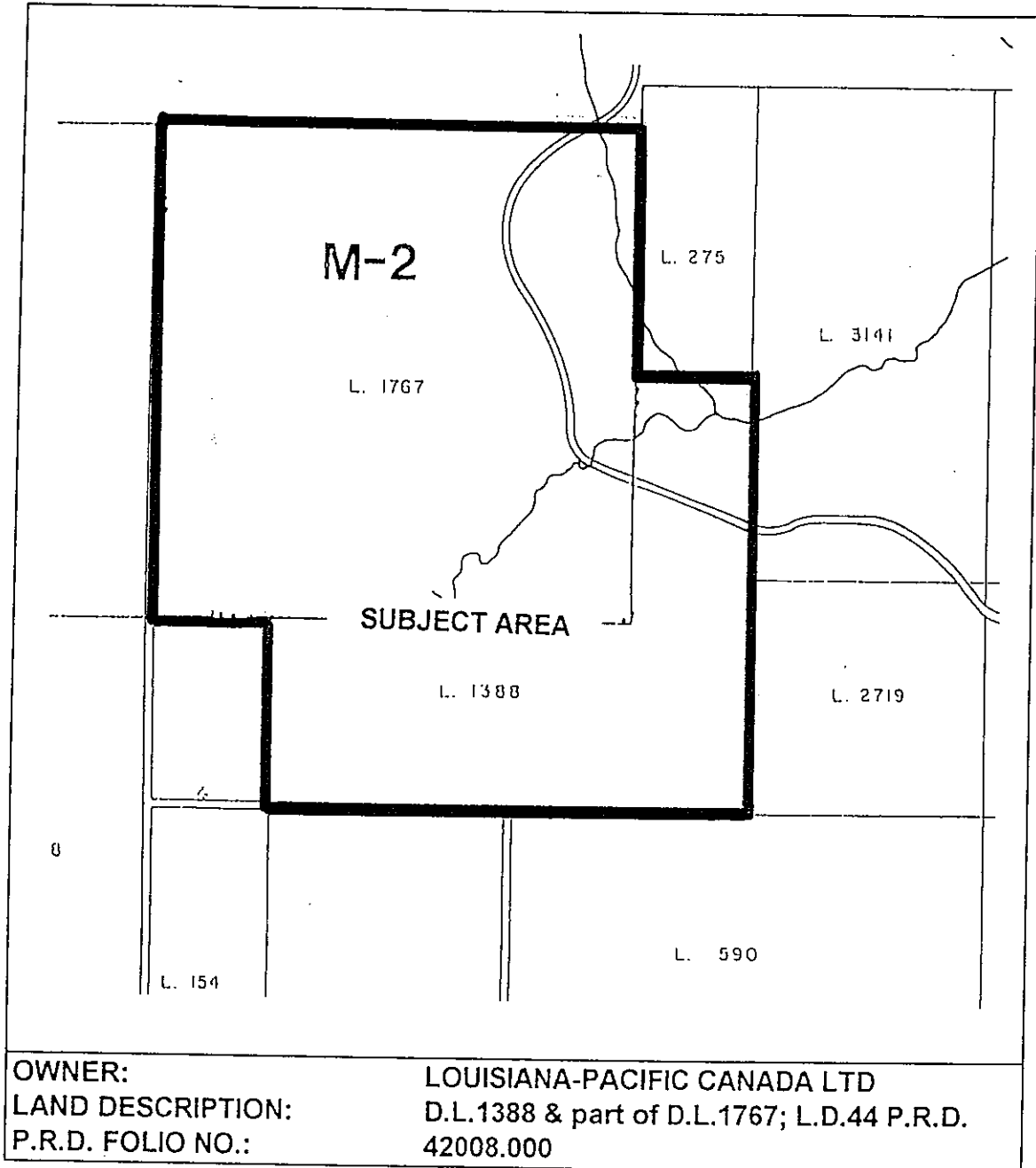

OWNER:  
LAND DESCRIPTION:  
P.R.D. FOLIO NO.:

LOUISIANA-PACIFIC CANADA LTD  
D.L.1388 & part of D.L.1767; L.D.44 P.R.D.  
42008.000



# DISTRICT OF CHETWYND

## PROPOSED BOUNDARY EXPANSION

SEPTEMBER - 1995

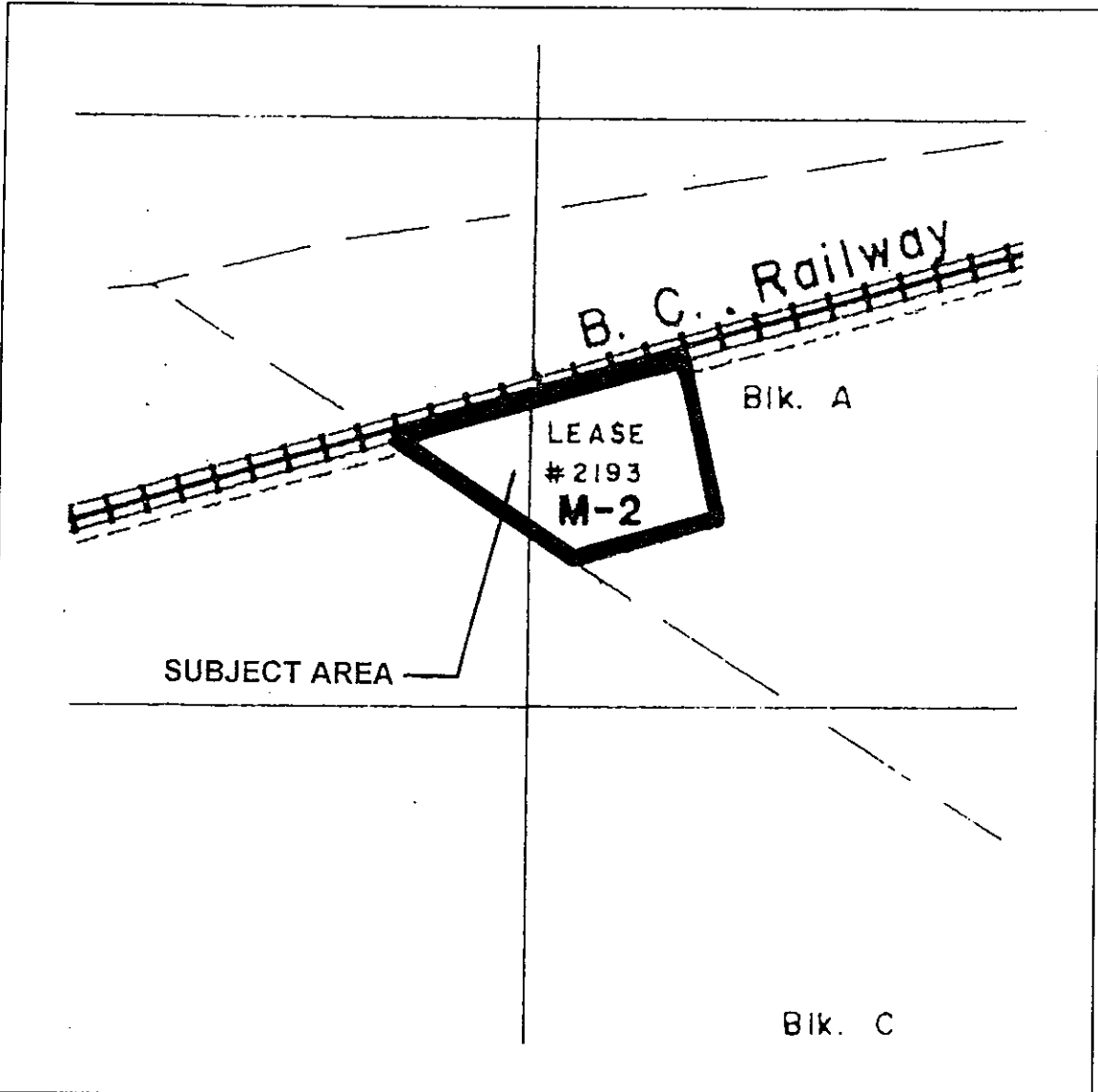

OWNER:	BC RAIL LTD
LAND DESCRIPTION:	BCR LEASE #2193 PETROSUL INTERNATIONAL LTD
P.R.D. FOLIO NO.:	53002.015



# DISTRICT OF CHETWYND

## PROPOSED BOUNDARY EXPANSION

SEPTEMBER - 1995

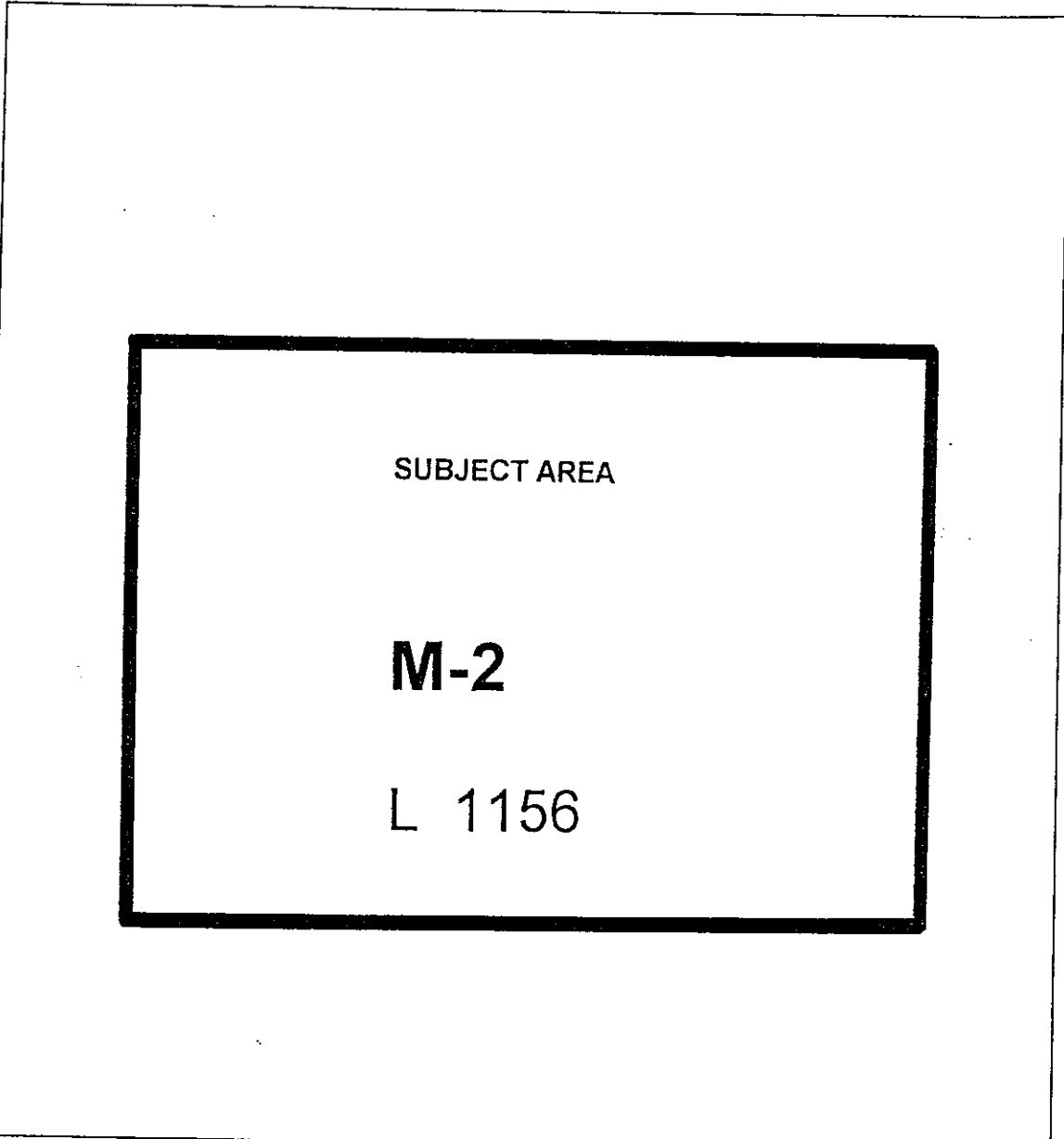

OWNER:	WESTCOAST ENERGY INC
LAND DESCRIPTION:	D.L.1156; L.D.44 P.R.D.
P.R.D. FOLIO NO.:	41420.000



# DISTRICT OF CHETWYND

## PROPOSED BOUNDARY EXPANSION

SEPTEMBER - 1995

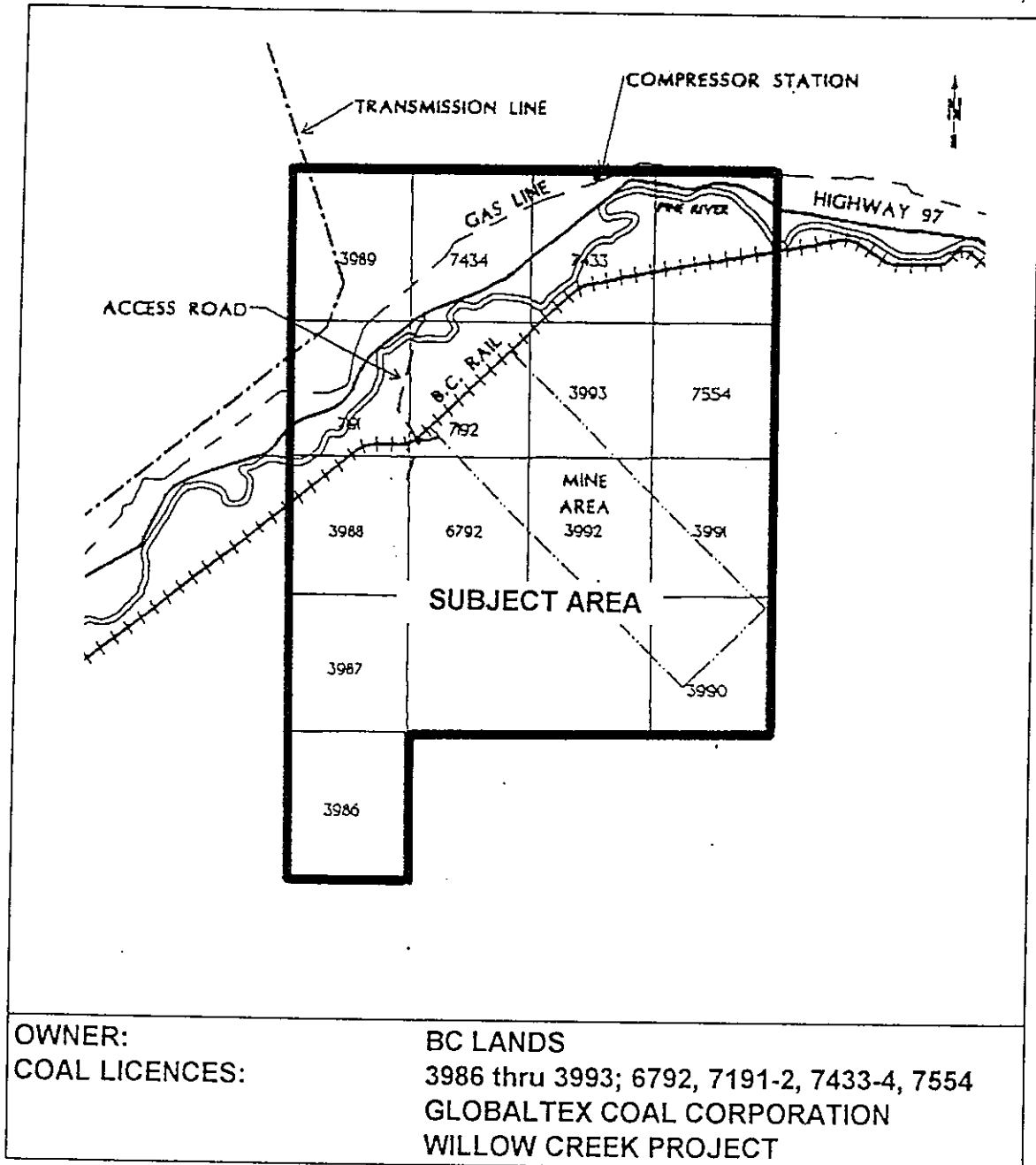

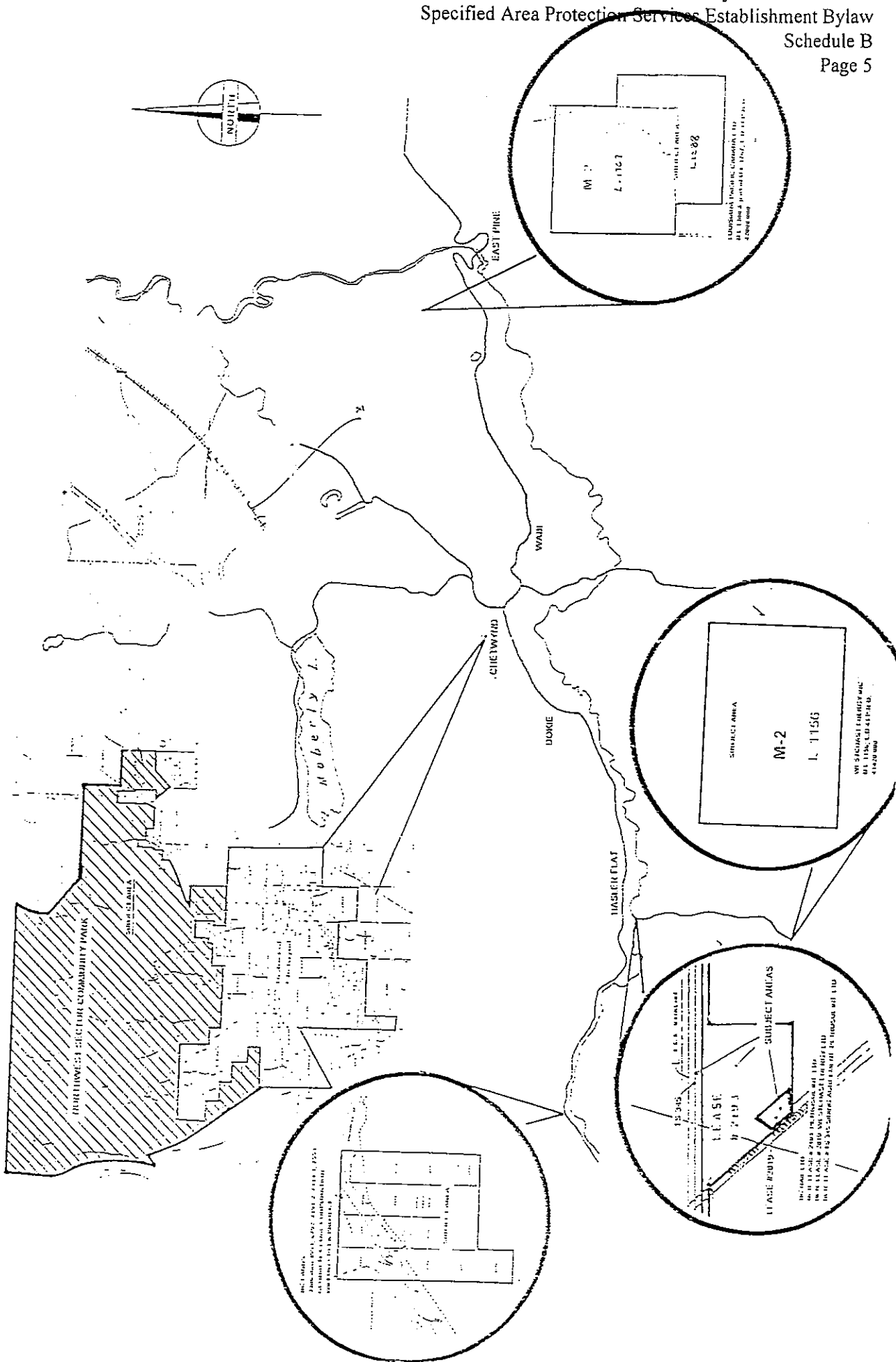

- 4) the specified area established by this bylaw may be merged with any other specific area or areas for the same purpose, whether contiguous or not in the manner provided in Section 650 subsection (4) of the *Municipal Act*.

Read a First Time This      20th              day of May, 1997.

Read a Second Time This    20th              day of May, 1997.

Read a Third Time This     20th              day of May, 1997.

ADOPTED THIS                3rd                day of June, 1997.

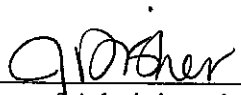
  
\_\_\_\_\_  
Director of Administration  
(Clerk)

  
\_\_\_\_\_  
Mayor

I hereby certify the foregoing to be a true and correct copy of Bylaw No. 691/G/97 cited as "District of Chetwynd Fire Specified Area Protection Services Establishment Bylaw No. 691/G/97" as adopted by Council the 3rd day of June, 1997.

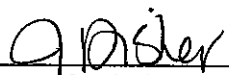
  
\_\_\_\_\_  
Director of Administration  
(Clerk)